



The area of the campsite .

CAMPSITE AND ENVIRONMENT

We are located 1.5 km from the picturesque village of Chateauneuf du Pape, famous for its wine(20min walking). In the village there are a bakery, a pharmacy, a medical center, a grocery shop,a gas station and a lot of wineshops. (maps are available at the reception, come and ask us!).

Chateauneuf du pape is located between Avignon et Orange.

ART DE VIVRE IN THE CAMPSITE

For everyone's well being and children safety, please be careful with your car and drive very slowly (5km/h) in the campsite.

Pets must be kept on a lead, and their behavior has to be respectful of the other campers: pets are forbidden in the common areas, as the swimming pool or bathrooms.

Any outdoor fire is strictly forbidden.

Barbecues are allowed under certain conditions. Information at the reception.

Please do not make any noise during the night, we ask you to respect your neighbour and be quiet from 10.00 p.m. to 8.00 a.m.

For everybody's comfort, the campsite's gate is closed from 10.00 p.m. to 8.00 a.m. During this time, your car will have to be parked outside.

If any visitor is coming to see you, please inform the reception when they arrive. Their cars have to stay parked outside.(more than 2hours, visitor's rate) No visitor after 10.00 p.m

No access for visitors at the swimming pool.





SERVICES

THE RECEPTION

We are open everyday.

Opening hours are different depending of the season and written on the door.

July and August : 9 a.m to 1p.m and 3p.m to 8p.m.

If no one is there, you can ring the bell, we are never really far. :)

At your disposal :

-touristic information

-postcards and stamps, wine to take away.

- washing machine and dryer coins
- -bike rental (by reservation)

-tennis court rental

-bread, pastries and breakfast : it has to be ordered the day before

. You can pick it up from 8.30 to 10.00 a.m at the bar.

Free Wifi access: network « Art de vivre », password at the reception.



THE BAR

In July and August open from **8.30 à 10.00 a.m and from 4.30 to 11.00 p.m.**

Out of these opening hours,feel free to ask us for a drink.

THE RESTAURANT

It is open **from 6.00 to 9.30 p.m.**

You can find the menu on the slate at the entrance of the restaurant

SWIMMING POOL

Opening hours: from 10.00 a.m to 7.30 p.m

It's a nice and quiet place, only for campers!

Dips, floating craft, food and long short bath are not allowed.

Children must come with their parents.

Don't forget to take off your shoes and take a shower before entrance.

There is a security door for children at the entrance of the pool, please keep it closed !

GARBAGE

Selective sorting : at the entrance of the campsite, you will find green bins dedicated to general waste, the yellow bin is for cans, plastic and cartons and the last one is a glass container.

We live in a natural zone : please do not throw your butts on the floor. Ashtrays are available at the bar.

ACTIVITIES

In l'Art de Vivre you can enjoy a quiet atmosphere. But some animations are organized during the high season :

- Thursday's evening : starting from 6.30 p.m , free wine tasting. At the same time, minigolf tournament for kids



- For children (and their parents), we organized a discovery of archery (dates at reception).

The meeting takes place in front of the reception.

- orienteering to do with family is available at the reception

- a treasure hunt inside the campsite is organized on Tuesday morning

- Music concerts take place at the bar once every other week.

YOUR PITCH

Thank you kindly respect the cleanliness of common areas, as well as your pitch.

PLEASE PAY YOUR STAY THE DAY BEFORE LEAVING

SUPERMARKET AND GAS STATION closest to the campsite.

Intermarché Sorgues (direction Avignon)

Marché U Courthézon (direction Orange)

You could find useful information in the showcase outside of the reception.



WE WISH YOU A PLEASANT STAY!



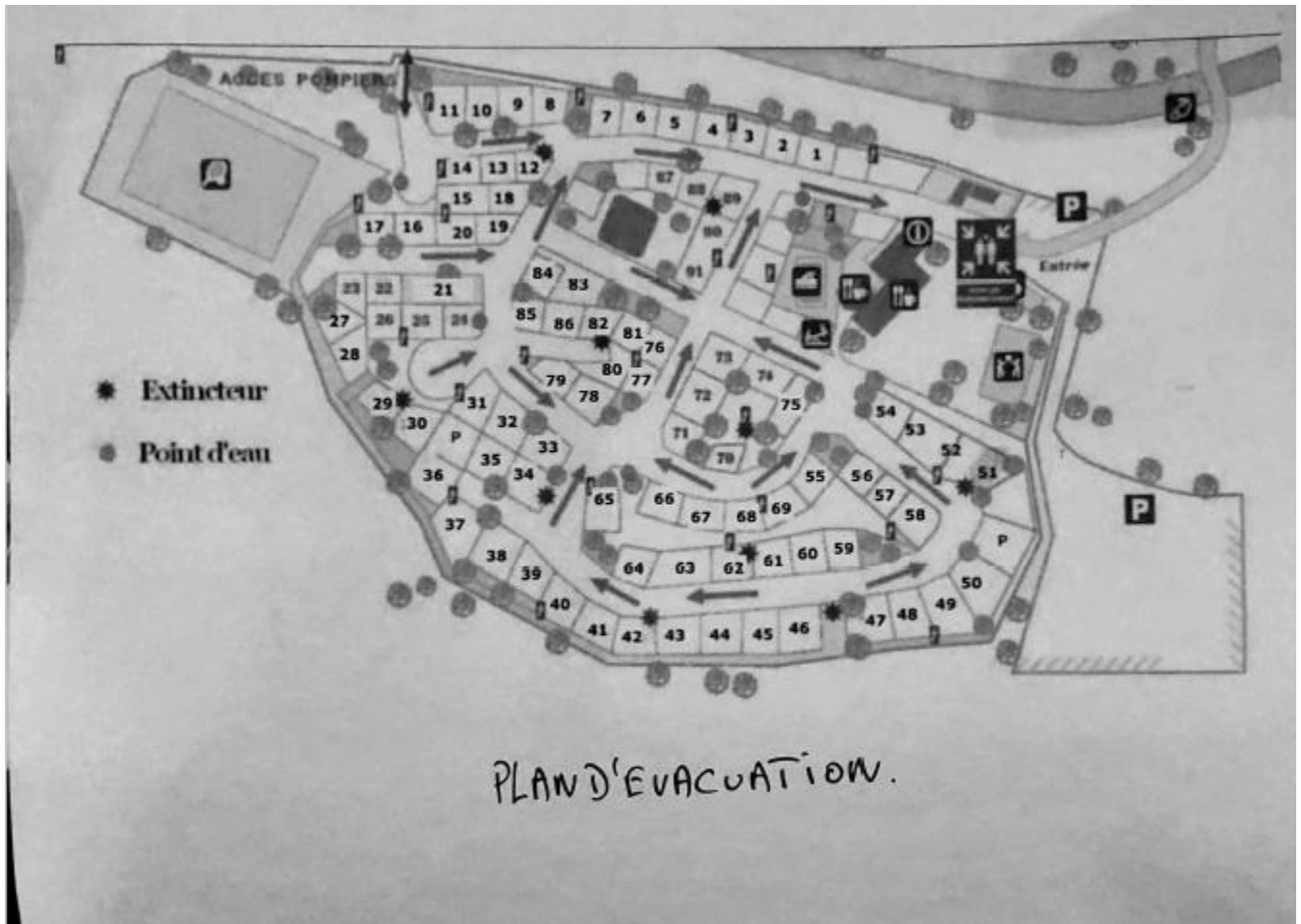

PLAN D'EVACUATION.